



DEBRA SWANN

DWELLING

THURSDAY 9 OCTOBER – WEDNESDAY 29 OCTOBER 2014

Dwelling is a solo exhibition by Debra Swann consolidating her artistic research through sculpture, video and photography.

Dwelling is an exploration of the domestic space and the personas that may evolve through these spaces. Thinking about the repetition of tasks and the familiar sites of the home, narratives are created to comment on relentless labour and the strangeness of the comings and goings of the home.

A number of historic locations become backdrops, stages or sites for making work. The re-contextualization of objects made for such places take the viewer through subtle juxtapositions of time and reality. Blurring the relationship between fact and fiction the viewer questions what they are looking at and the process by which history is written and how we establish truth.

ARTIST BIOGRAPHY

Debra Swann graduated from Goldsmiths College in 2001 with an MA in Fine Art. She has undertaken residencies at Spode Factory in Stoke; Artspace in Sydney, Australia; Coleman Project Space in London; Tether in Nottingham and Ecole Cantonale D'art du Valais in Switzerland.

Recent exhibitions include *Pile* at Chapter Gallery, Cardiff (2011); *Event Horizon*, Primary (2012); *Seconds*, Lace Market Gallery, Nottingham; and *Long Time Dead*, Space Station Sixty-Five (2013).

WWW.BONINGTONGALLERY.CO.UK

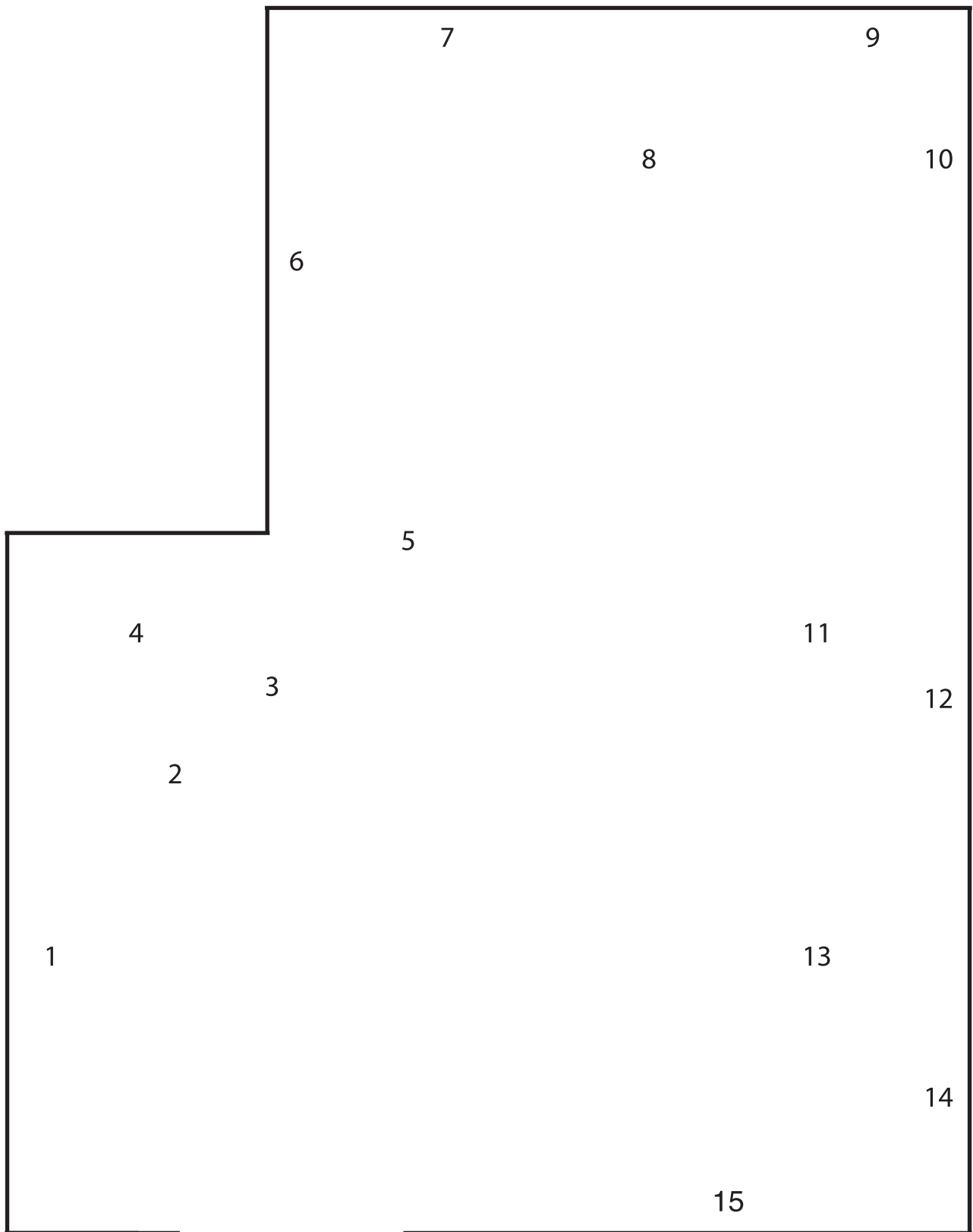

- 1 *Climbing*
- 2 *Relic (Dust Pan)*
- 3 *Shard*
- 4 *Family Portrait (Shrunken Heads)*
- 5 *Relic (Broom)*
- 6 *Mary Colinwood's Notches*
- 7 *Calling*
- 8 *Effigy(Organism)*

- 9 *Effigy (Horns)*
- 10 *Effigy*
- 11 *Relic (Saucepan)*
- 12 *Pidge*
- 13 *Relic (Tin Bath)*
- 14 *Still Life*
- 15 *Pieces*