

SARA MACKILLOP

ONE ROOM LIVING

FRIDAY 3 NOVEMBER – FRIDAY 8 DECEMBER 2017

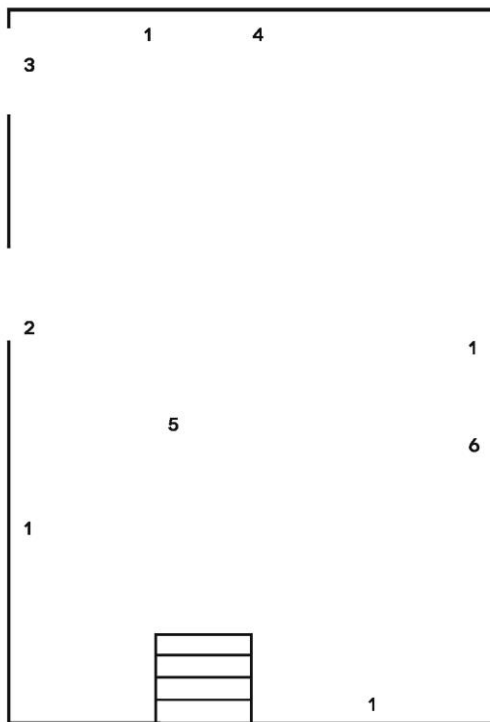

1. *Ikea Plant*, 2017, digital print on fly poster, dimensions variable
2. *Loyalty Map*, 2017, digital print, 42 x 52 cm
3. *Pen Fence 5*, 2017, digital print on vinyl installed on steps and wall, dimensions variable
4. *Slush Machine*, 2017, Found working object on trolley, dimensions variable
5. *Pen Fence 6*, 2017, digital print on vinyl, not installed, dimensions variable
6. *PaintBrushes*, 2017, digital print on photographic paper, Ikea Kitchen handles, dimensions variable

One Room Living presents a series of works and interactions that reference the wide variety of spatial uses that directly surround Bonington Gallery – analysing not only the gallery’s site and situation, but also how the wider institution’s function is represented across a multitude of spaces.

Sara's work demonstrates a strong relationship between printed matter and sculptural form. Accompanying this exhibition is a display of her published and self-published book-works, from 2008 to 2017, housed within the Bonington Vitrines in the gallery foyer.

When Sara joined us for her first visit to the gallery she was immediately captivated by the experience of walking through the Bonington building, she explains:

“On my first visit I was very conscious of the different uses of space I encountered on the way to the gallery itself – the cafe, art shop etc... In a way it made sense to me for the exhibition to appear as a repository for motifs of these spaces and I am interested to see what happens when they overlap.

When there is a printed image I am immediately interested in what it is printed on, if there is something on the other side. This is maybe something to do with a use of found or altered objects or images of various kinds and looking at the wrong aspect of them – or approaching it in a non-straightforward fashion.”

Visit www.boningtongallery.co.uk/blog to read the full in-conversation piece.

Reference copies are available from our gallery invigilator.

This exhibition is supported by the Elephant Trust.